

Traditional for wave soldering

For resined PCB

Suitable for the EX areas

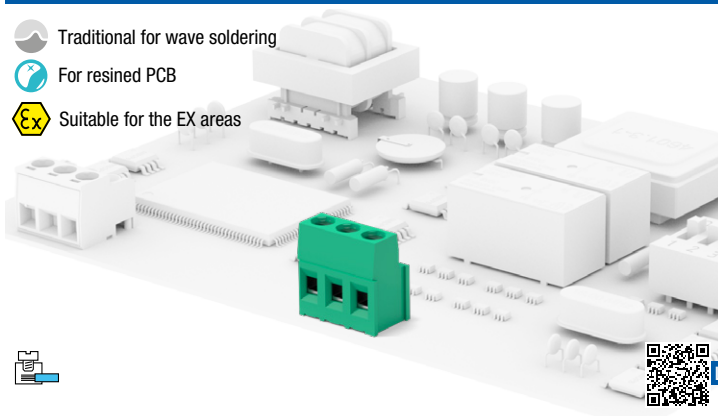

Last release

Your drawings and notes

### General data

<b>Dimensional class:</b>	medium
<b>Standard colour:</b>	green
<b>Pitches:</b>	metric 5 mm, 7.5 mm, 10 mm (.197 in, .295 in, .394 in) imperial 5.08 mm, 7.62 mm, 10.16 mm (.200 in, .300 in, .400 in)
<b>Screw dimension:</b>	M3
<b>Recommended/highest tightening torque:</b>	0.5/0.6 Nm (4.42/5.31 lbf-in)
<b>PCB thickness:</b>	max. 2.4 mm (.094 in)
<b>PCB hole diameter:</b>	min. 1.4 mm (.055 in)
<b>Stripping length:</b>	5.5 ÷ 6.5 mm (.22 ÷ .26 in)
<b>Operating temperature range</b>	-40 °C ÷ +105 °C (-40 °F ÷ +221 °F)
<b>Contact resistance:</b>	<15 mΩ
<b>Insulating material group:</b>	I (CTI ≥ 600V)
<b>Self-extinguishing class UL94:</b>	V0
<b>Insulation resistance:</b>	>10 <sup>9</sup> Ω (500V DC)

### Certifications

#### UL (n. E167473)

300 V - 17.5 A - 30÷12 AWG - for 5 mm, 5.08 mm, 7.5 mm and 7.62 mm pitch  
600 V - 17.5 A - 30÷12 AWG - for 10 mm and 10.16 mm pitch

#### VDE (n. 40022745)

250 V - 24 A - 2.5 mm<sup>2</sup> - for 5 mm and 5.08 mm pitch  
750 V - 24 A - 2.5 mm<sup>2</sup> - for 7.5 mm, 7.62 mm, 10 mm and 10.16 mm pitch

#### IMQ (n. EA022)

250 V - 24 A - 2.5 mm<sup>2</sup> - for 5 mm and 5.08 mm pitch  
750 V - 24 A - 2.5 mm<sup>2</sup> - for 7.5 mm, 7.62 mm, 10 mm and 10.16 mm pitch

#### CSA (n. LR102896)

300 V - 17.5 A - 30÷12 AWG for 5 mm, 5.08 mm, 7.5 mm and 7.62 mm pitch  
600 V - 17.5 A - 30÷12 AWG for 10 mm and 10.16 mm pitch

Application values for end-use equipment have to be in accordance to norms and applicable to it.  
The certifications of some product's versions could be pending, for more detailed and updated data please refer to our web site [www.sauro.net](http://www.sauro.net) or your representative Sales Manager.

A higher number of poles is obtained by combining together **modular** parts.

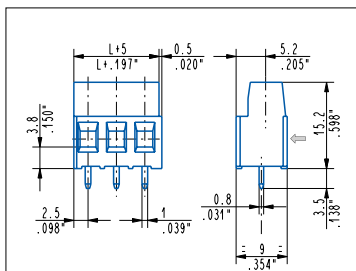

#### 0°, modular

**MSS\_001** - 2÷25 poles, 5 mm / .197" pitch  
**MSS\_003** - 2÷4 poles, 7.5 mm / .295" pitch  
**MSS\_002** - 1÷13 poles, 10 mm / .394" pitch  
**MSS\_005** - 2÷25 poles, 5.08 mm / .200" pitch  
**MSS\_007** - 2÷3 poles, 7.62 mm / .300" pitch  
**MSS\_006** - 1÷13 poles, 10.16 mm / .400" pitch

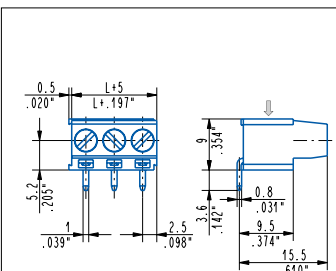

#### 90°, modular

**MSS\_091** - 2÷25 poles, 5 mm / .197" pitch  
**MSS\_093** - 2÷4 poles, 7.5 mm / .295" pitch  
**MSS\_092** - 1÷13 poles, 10 mm / .394" pitch  
**MSS\_095** - 2÷25 poles, 5.08 mm / .200" pitch  
**MSS\_097** - 2÷3 poles, 7.62 mm / .300" pitch  
**MSS\_096** - 1÷13 poles, 10.16 mm / .400" pitch

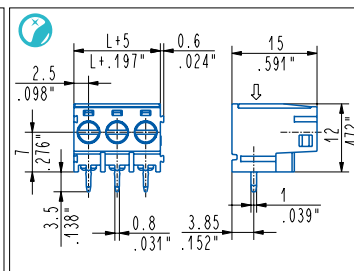

#### 90° "T" version, modular

**MSS\_TM1** - 2÷18 poles, 5 mm / .197" pitch  
**MSS\_TM3** - 2÷3 poles, 7.5 mm / .295" pitch  
**MSS\_TM2** - 1÷9 poles, 10 mm / .394" pitch  
**MSS\_TM5** - 2÷3 poles, 5.08 mm / .200" pitch  
**MSS\_TM7** - 2÷3 poles, 7.62 mm / .300" pitch  
**MSS\_TM6** - 1÷2 poles, 10.16 mm / .400" pitch

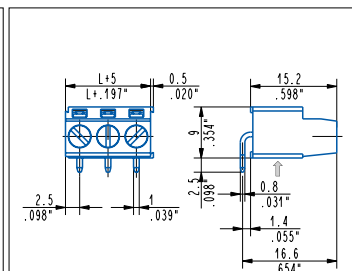

#### 270°, modular

**MSS\_051** - 2÷25 poles, 5 mm / .197" pitch  
**MSS\_053** - 2÷4 poles, 7.5 mm / .295" pitch  
**MSS\_052** - 1÷13 poles, 10 mm / .394" pitch  
**MSS\_055** - 2÷25 poles, 5.08 mm / .200" pitch  
**MSS\_057** - 2÷3 poles, 7.62 mm / .300" pitch  
**MSS\_056** - 1÷13 poles, 10.16 mm / .400" pitch

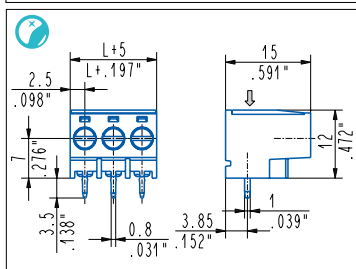

#### 90° "T" version, side stackable

**MSS\_TA1** - 2÷18 poles, 5 mm / .197" pitch  
**MSS\_TA2** - 2÷9 poles, 10 mm / .394" pitch

