

With Sauro bridges a short circuit between adjacent poles of the terminal blocks and the connectors is obtained, at the same time enabling wiring to be carried out. They can be used as bridges on the PCBs as they have tapered ends. Sauro bridges for short circuit meet the safety and environmental requirements demanded by the strictest international standards. The metallic part is made by copper alloy with a lead free tin treatment surface and the insulating part is made by

PA 6.6 Polyamide which is V0 class self-extinguishing according to UL94.

They are available from 2 to 9 poles and it is possible join them together in order to obtain any number of poles.

Sauro bridges for short circuit can be supplied already mounted on the products according to the client's design-in.

Rated current: 12 A (In any case not pass the current rate of the product where the bridge is used).

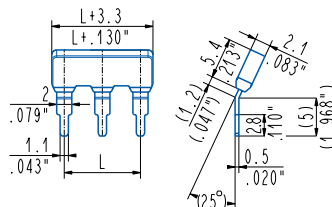

Bridges for short circuit for screw-type products

- BSC_000-OR** - 2 ÷ 9 poles, 5 mm, 5.08 mm / .197", .200" pitch
- BSC_003-OR** - 2 ÷ 6 poles, 7.5 mm, 7.62 mm / .295", .300" pitch
- BSC_002-OR** - 2 ÷ 5 poles, 10 mm / .394" pitch
- BSC_006-OR** - 2 ÷ 5 poles, 10.16 mm / .400" pitch

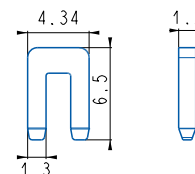

Internal bridges for short circuit for MCM series

- MCM-BSC1** - 2 poles, 5 mm / .197" pitch
- MCM-BSC5** - 2 poles, 5.08 mm / .200" pitch
- MCM-BSC3** - 2 poles, 7.5 mm / .295" pitch
- MCM-BSC7** - 2 poles, 7.62 mm / .300" pitch
- MCM-BSC2** - 2 poles, 10 mm / .394" pitch
- MCM-BSC6** - 2 poles, 10.16 mm / .400" pitch

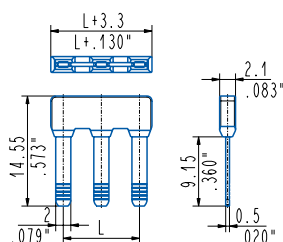

Bridges for short circuit for push-in products

- BSC_0C0-OR** - 2 ÷ 9 poles, 5 mm, 5.08 mm / .197", .200" pitch
- BSC_0C3-OR** - 2 ÷ 6 poles, 7.5 mm, 7.62 mm / .295", .300" pitch
- BSC_0C2-OR** - 2 ÷ 5 poles, 10 mm / .394" pitch
- BSC_0C6-OR** - 2 ÷ 5 poles, 10.16 mm / .400" pitch

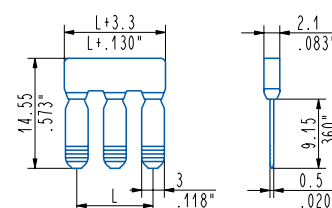

Bridges for short circuit for MCM series

- BSC_0L1-OR** - 2 ÷ 9 poles, 5 mm / .197" pitch
- BSC_0L5-OR** - 2 ÷ 9 poles, 5.08 mm / .200" pitch
- BSC_0L2-OR** - 2 ÷ 5 poles, 10 mm / .394" pitch
- BSC_0L6-OR** - 2 ÷ 5 poles, 10.16 mm / .400" pitch